

CRYSTAL UNIT

XTL57



Applications

- Bluetooth / Wireless LAN
- Wearable Devices
- LTE / SAS

Features

- Ultra thin / Dimensions (3.2×2.5×0.7)
- Ceramic Package
- High Reliability and High Stability
- Tight Tolerance and Stability
- Reflow Soldering / Emboss Taping

Specifications



Model	XTL57			
Nominal frequency range	8.000~54.000MHz		54.000~125.000 MHz	
Crystal cut	Fundamental [AT-cut]		3rd overtone [AT-cut]	
Storage temperature range	-40~+90°C			
Operating temperature range	-30~+85°C	-40~+105°C	-30~+85°C	-40~+105°C
Frequency temperature characteristics(Ref. to +25°C)	± 15 × 10 ⁻⁶	± 30 × 10 ⁻⁶	± 15 × 10 ⁻⁶	± 30 × 10 ⁻⁶
Frequency tolerance (at +25°C)	± 15 × 10 ⁻⁶			
Equivalent series resistance	400 Ω : 8.000~9.799 MHz 150 Ω : 9.800~15.999 MHz 80 Ω : 16.000~18.999 MHz 60 Ω : 19.000~29.999 MHz 40 Ω : 30.000~54.000 MHz		100 Ω : 54.000~125 MHz	
Load capacitance	8,10,12 pF or specify			
Shunt capacitance	3pF max.			
Level of drive	10 μW (100 μW max.)			

Package quantity: 3,000pcs max./Reel.

Outline and Dimensions [unit:mm]

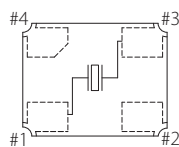
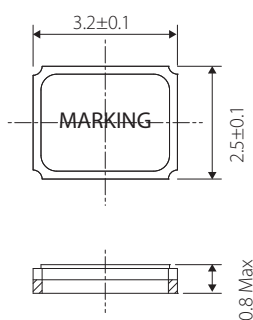

Land Pattern(REFERENCE)

Pin Connection	
#1,#3	Crystal
#2,#4	GND

